

IPPC Documents

C1.4.2

Waste recycling facility and baling plant

Hal Far, l/o Birżebbuġa

Variation of IP0004/12/A

Dr. Joe A Doublet PhD (Wales)

Applicant

Damian Whitehead

Architect

Perit Joe Grech B.E.& A. (Hons), A.& C.E.

November 2020

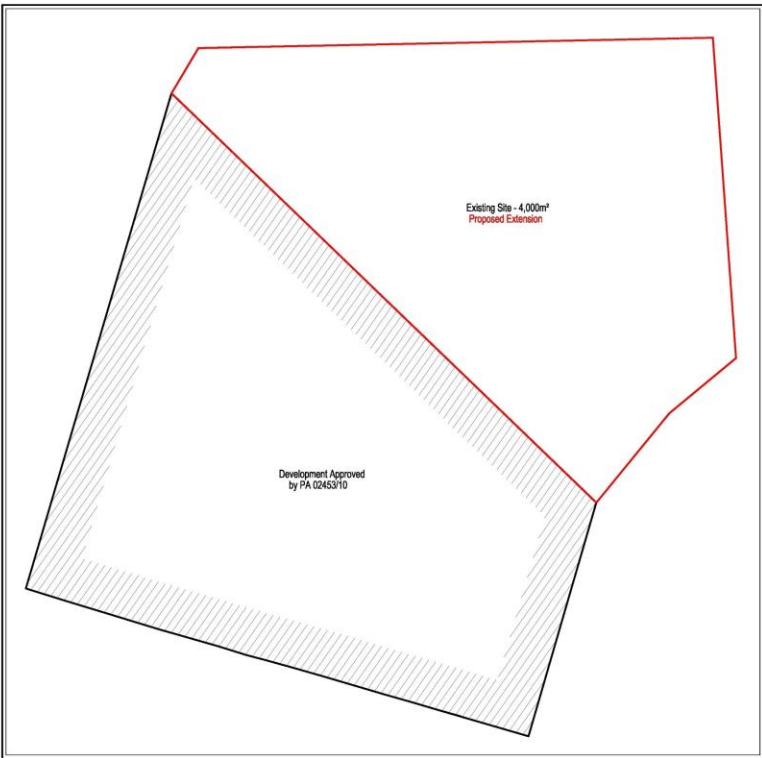

BLOCK PLAN
Scale 1:500

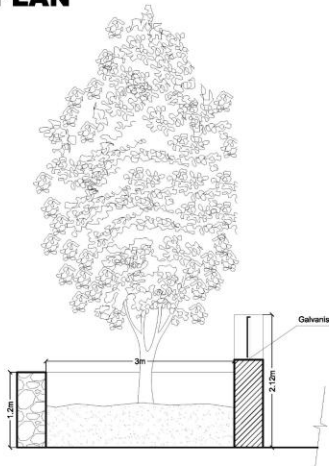

Part Section A
Scale 1:50

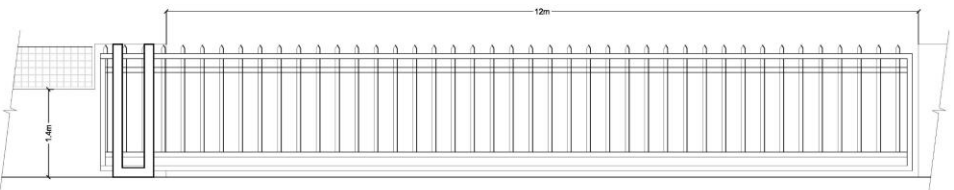

Gate Detail
Scale 1:50

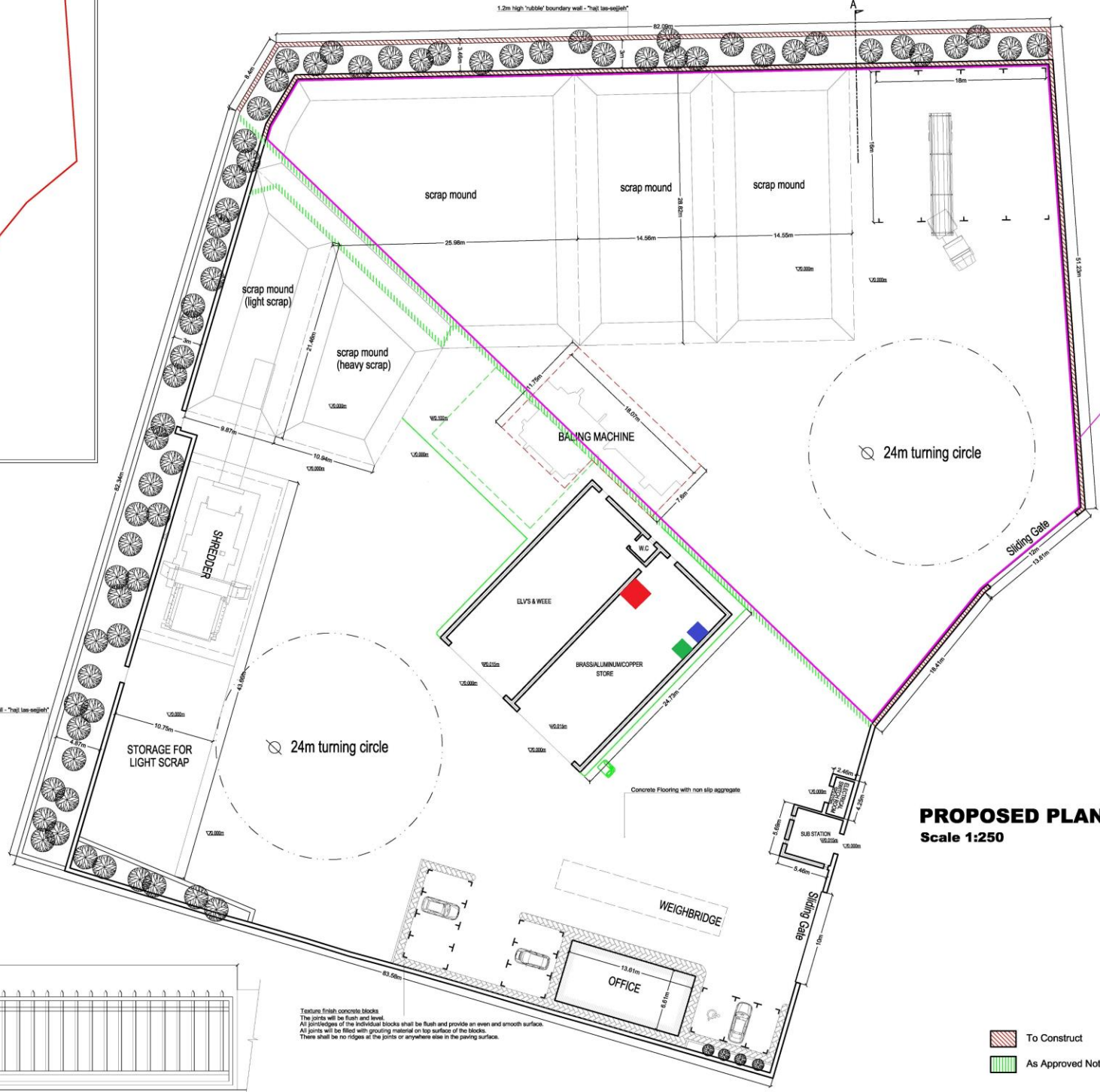

PROPOSED PLAN
Scale 1:250

- Proposed cable/ wire shredder
- Wire/ cable stripper
- Shearer & Baler

- To Construct
- As Approved Not To Be Constructed

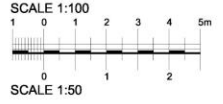

REV	DESCRIPTION	DATE
1	ISSUED FOR PERMIT	14/05/14
2	ISSUED FOR PERMIT	14/05/14
3	ISSUED FOR PERMIT	14/05/14
4	ISSUED FOR PERMIT	14/05/14
5	ISSUED FOR PERMIT	14/05/14
6	ISSUED FOR PERMIT	14/05/14
7	ISSUED FOR PERMIT	14/05/14
8	ISSUED FOR PERMIT	14/05/14
9	ISSUED FOR PERMIT	14/05/14
10	ISSUED FOR PERMIT	14/05/14

JOE GRECH
REGISTERED ARCHITECT
No. 10100
14/05/14
PA 02453/10
Block Plan & Proposed Plans
Mr. Geoffrey Cullen
May'14
C.A.
A1.1.250
14045-03.01